



version 00  
A80204002

# Notice

Volet pivotant 180°

400 x 1950 x 6 mm

802040

# Composants

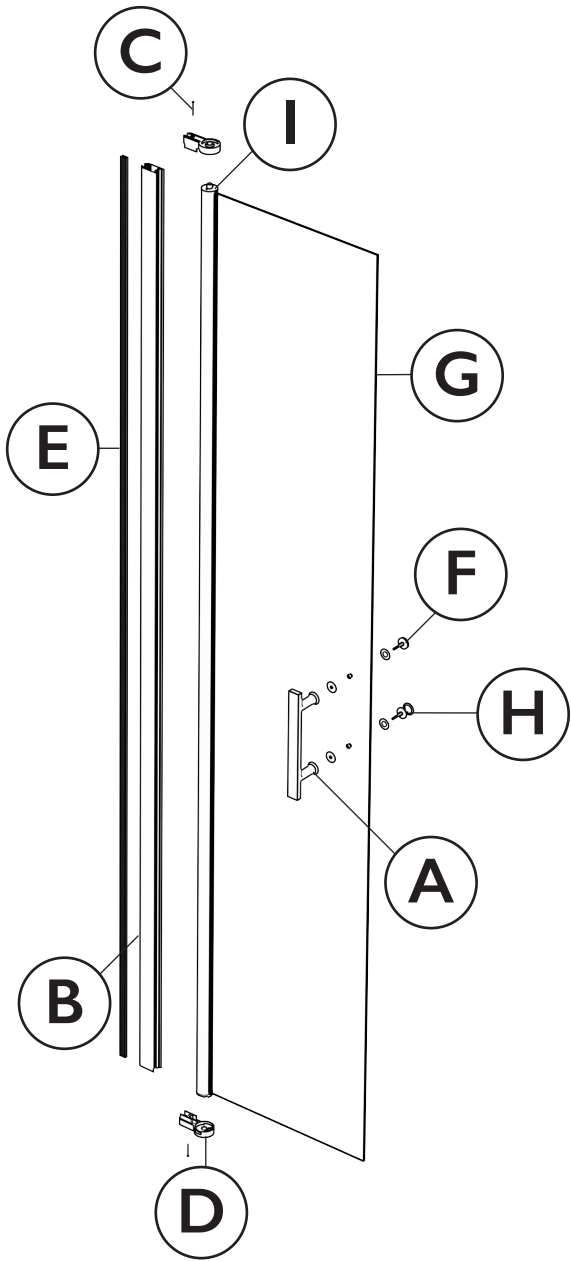

Code	Dénomination	Quantité
A	Poignée	1
B	Profilé	1
C	Vis	6
D	Pièce de jonction	2
E	Joint nervuré	1
F	Bouchon avec pas de vis	1
G	Vitre	1
H	Mini poignée avec pas de vis	1
I	Tube pivot	1

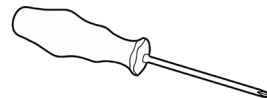

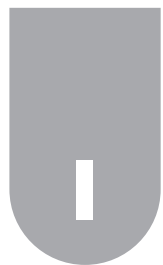

Fixer le pivot sur la  
paroi

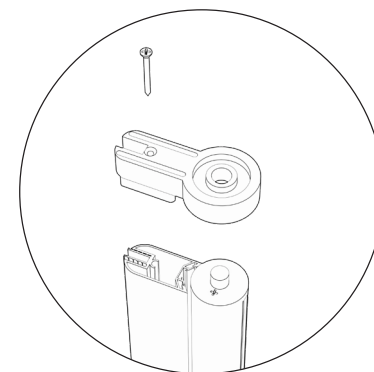
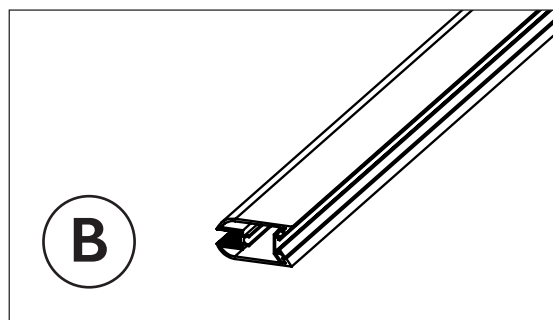

1- Dévisser le cache  
supérieur

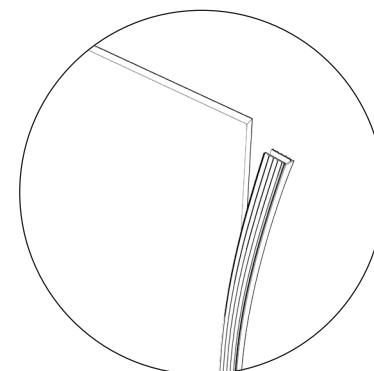

2- Placer le joint  
sur la paroi fixe

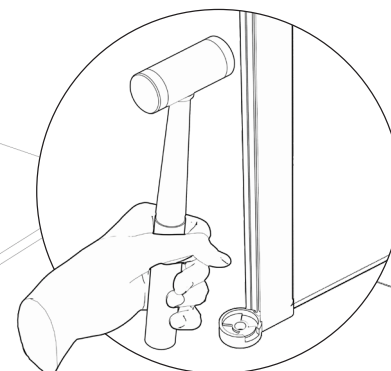

3- Enfoncer le pivot  
dans la paroi fixe

2



Attacher la vitre sur  
le pivot

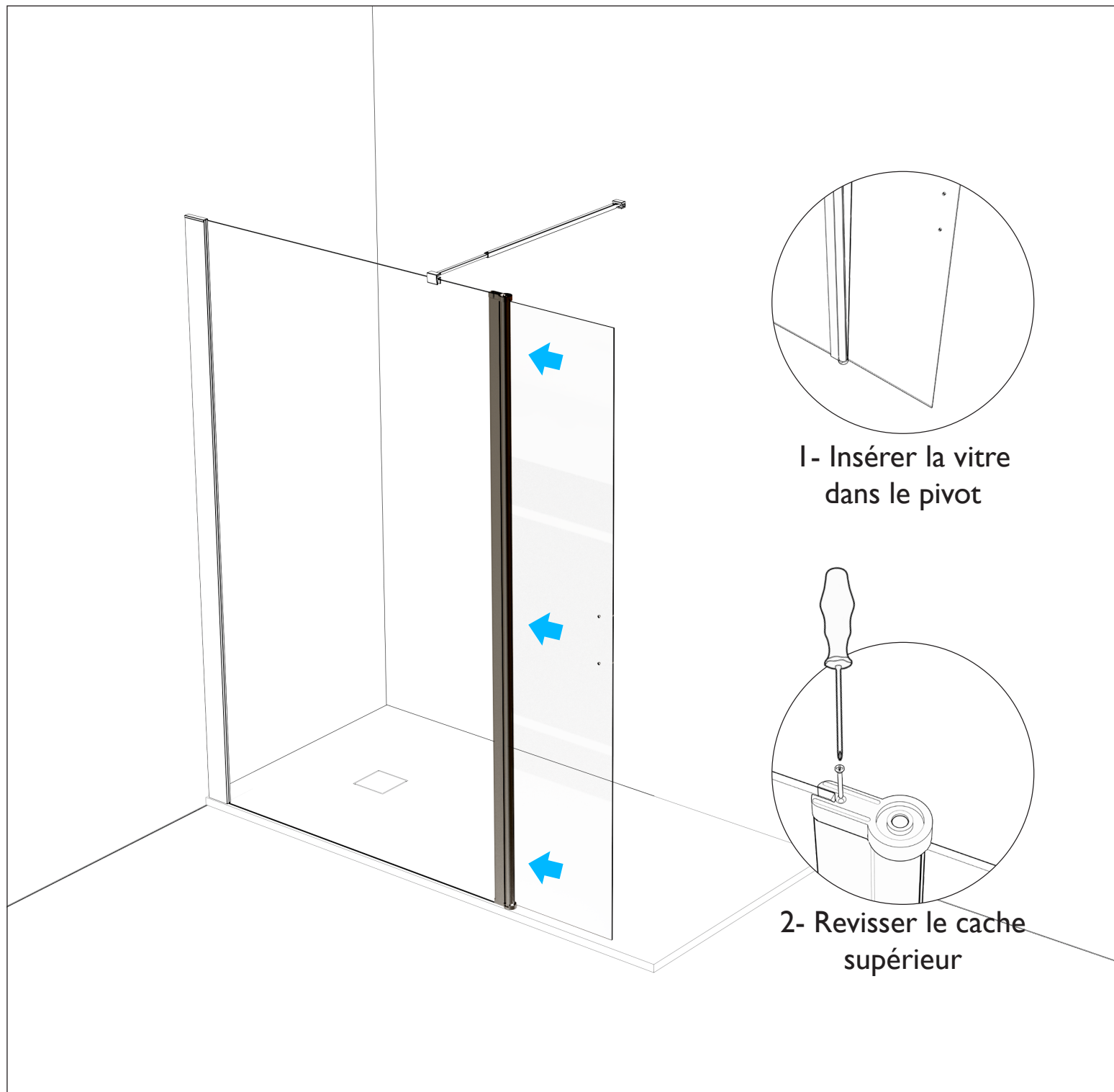
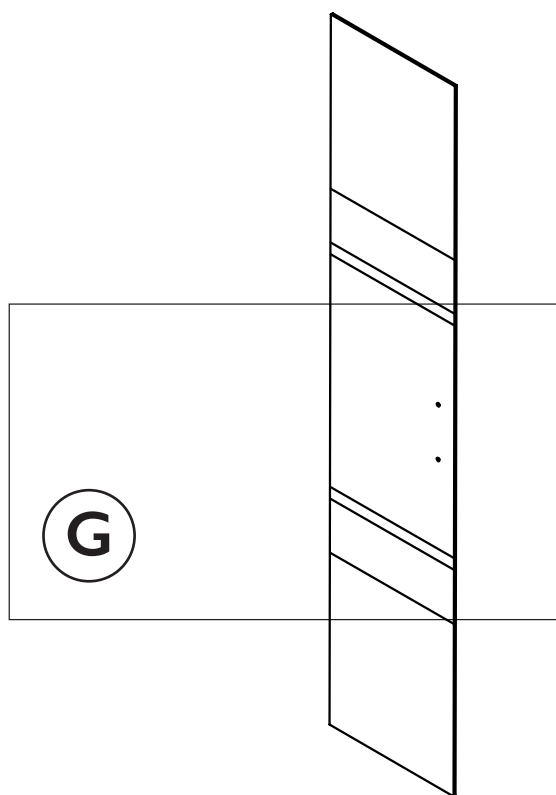

1- Insérer la vitre  
dans le pivot

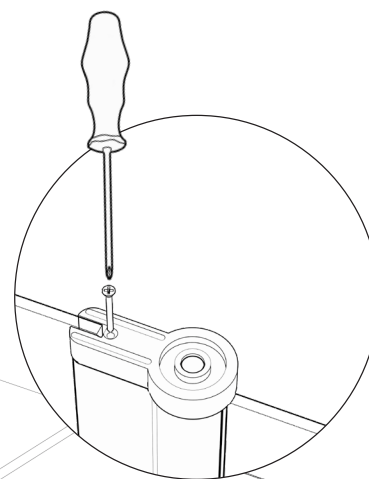

2- Revisser le cache  
supérieur

3

Fixer la poignée

A

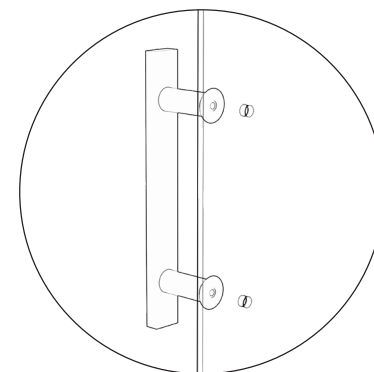
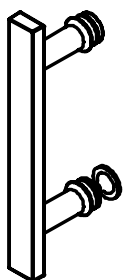

1- Positionner la poignée

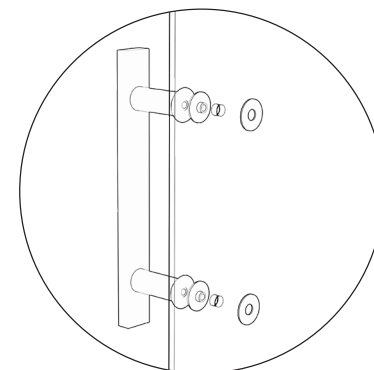

2- Placer les rondelles

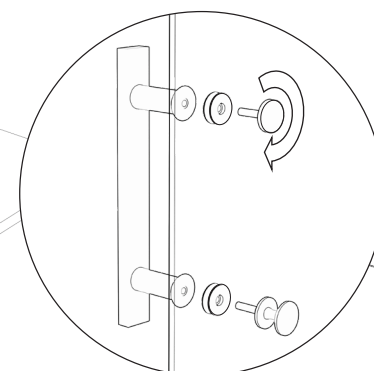

3- Visser